

Step 1

Firstly, pass the spindle through the follower hole in your door, with the coin release that is already attached.



Step 2

Attach the thumbturn to the other side of the door onto the spindle.

If the spindle is too long, measure the gap and then cut down with a hacksaw to suit your door thickness.



Step 3

Position the backplate so that the fixing holes are at points North, East, South and West and mark these points with a pencil.

It is important that these points are marked and drilled accurately to allow the bolt through fixings to pass through later in the process.

Now remove the set from the door again.



Step 4

For male & female bolts, drill holes large enough to allow M4 screws to pass all the way through the door.

Do not drill holes all the way through for the wood screw holes, only pilot holes are needed for these.

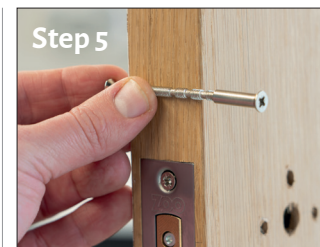

Step 5

Again, dependant on the thickness of your door, the male & female bolts may need to be cut down to size.

Position the bolts alongside the edge of the door to compare lengths, take into consideration the extra thickness needed for the thumbturn baseplate and cut away any excess length with a hacksaw. Your choice of latch or lock will determine how many bolts you may be able to use, fit wood screws in all other instances.

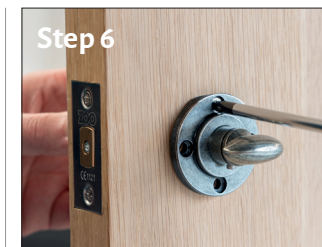

Step 6

Assemble the spindle and align with the previously drilled holes. Feed the male bolt through and connect the female end to the other side. Repeat for all bolts, evenly tightening with a hand-held screwdriver. If unable to use bolts, use wood screws to secure the baseplate to your door. When all bolts/screws are secured, fasten the grub screw on the thumbturn using the Allen Key and check all fixings are secure. The thumbturn should now function as expected.



Step 7

Place and screw on the outer rose covers until securely fastened against the surface of the door.

If you are using the Square/Diamond cover, please see the next two steps.



Step 8

To fasten the Square rose cover onto the thumbturn, slide the cover on and position it so that the angled grub screw will screw into the ground area on the threading.

Lightly screw in the grub screw using the Allen key provided to secure the cover in place.



Step 9

To fasten the Diamond rose cover onto the thumbturn, slide the cover on and position it so that the angled grub screw will screw into the ground area on the threading.

Lightly screw in the grub screw using the Allen key provided to secure the cover in place.



Concealed Thumbturn - Fitting Guide

Please note that this fitting guide is written on the assumption that a lock which is suitable for this product (with a 5mm follower hole) is already fitted to the door. Both wood screws & bolt through fixings (male & female bolts) are provided. Assuming your device allows, our recommendation would be to fit using the bolt through fixings for a more secure & stable fit.

From the
Anvil[®]
Specialist Manufacturers of Ironmongery & Lighting